



# CLERK'S CLIPS



JUNE 1, 2006

## MADISON COUNTY CHANCERY CLERK

Volume 1, Issue 1



Dear Friends,

I hope you find this inaugural edition of **Clerk's Clips** helpful and informative. We intend to publish this newsletter monthly in order to keep our customers up-to-date

on changes and improvements in the Chancery Clerk's office and in Madison county government in general. We intend to highlight staff members, share tips on recording topics, court matters, and delinquent tax issues, and give you information about Board of Supervisors actions and minutes.

We are very proud of our new internet search tools. Read on to find out more about these features, and I urge you to simply log on to our webpage and take it for a test drive. I would appreciate your suggestions and ideas for further improvements.

Our office strives to promote professionalism in the office, cooperation with other officials and agencies and hard work in our office, our hopes are to make things easier for you. Our website improvements are another step in that direction.

Best Regards,

# ARTHUR JOHNSTON

## MADISON COUNTY CHANCERY CLERK

P.O. BOX 404 · 146 W. CENTER ST. · CANTON, MS 39046

PHONE: (601) 855-5537 · FAX: (601) 859-0327

WEBSITE: WWW.MADISON-CO.COM · EMAIL: JOHNSTON@MADISON-CO.COM

### NEW WEB SEARCH TOOLS AVAILABLE

Try your search online at our improved website: [www.madison-co.com/elected\\_offices/chancery\\_clerk](http://www.madison-co.com/elected_offices/chancery_clerk)

The new features allow you to:

- Search all indices, including subdivisions & sectionals, by legal description for 6/1/88 to present.
- Search land roll, personal roll, current year taxes, delinquent taxes, and future redemption amounts.
- Search Board of Supervisors Minutes by both keyword and date for 7/1/01. Exhibits also available since 1/06.
- View and download instruments free of charge (for now) from 1997 to present.
- Search and view all subdivision plats and easily look up subdivision codes.
- View and print parcel/ownership maps and search county road registry.
- Search federal tax liens from 1995 to present.
- Search court dockets from 6/1/88 to present.

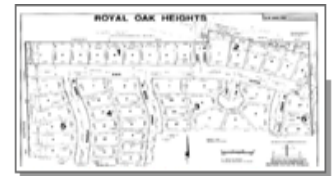

### Title Tips:

- Parcel maps are updated and replaced once every year.
- Type ALL and NONE in addition to the lot number the lot line to insure retrieval of all documents affecting the lot.
- All federal tax lien information is now computerized from 1/92.



### Passport Pointers:

- Passports and photos for passports are available in the Chancery Clerk's office.
- Normal waiting period to receive passport is 8 weeks or expediting to 2 weeks is available for an additional fee.



### Court Corner:

- 805 forms should be filed in all divorce cases, contested and non-contested. These forms are available in our office.
- Faxed copies are not accepted for filing except in emergencies approved by the clerk.